

SHERWOOD PARK MALL

www.sherwoodparkmall.com



KEY INFORMATION:

- 86 stores and services including a modern and bright food court
- latest re-development completed in 2019
- the only enclosed regional shopping centre located in Strathcona County
- CRU Productivity: \$441.13 psf (May 2022)
- approximate GLA: 390,000 square feet
- 2,294 Parking Stalls

LOCATION:

- in the heart of the community at 2020 Sherwood Drive
- situated on major arterial collector
- serviced by local transit routes
- surrounded by residential homes

MARKET:

- Sherwood Park is the urban component of Strathcona County
- 102,264 Total Trade Area Population
- 37,206 Total Trade Area Households
- \$165,754 Trade Area Average HH Income
- 61.2% Shoppers with income over \$100K

For a complete list of retailers and hours of operation, please visit the Centre's website at www.sherwoodparkmall.com

SHERWOOD PARK MALL IS ANCHORED BY:



Director of Leasing Pamela
dela Paz-Granum
403-984-1932
pgranum@primarisreit.com

General Manager
Seana Almer
780-417-0915
salmer@primarisreit.com

Specialty Leasing Manager
Joshua Thomas
780-458-2195
jthomas@primarisreit.com



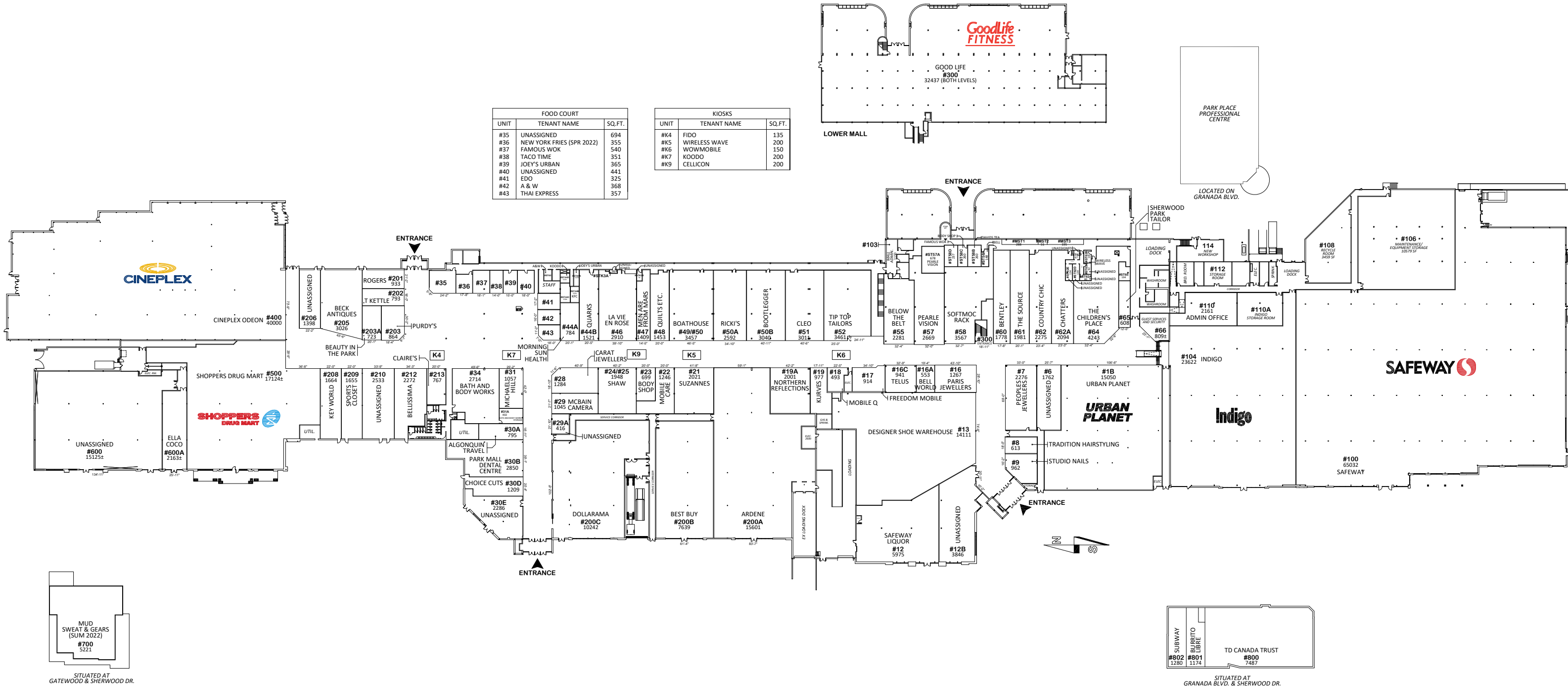

floor plan - main level

Primaris * June 02, 2022

The Purpose of this plan is to identify the approximate location, size and dimension of the Lease premises in the Shopping Centre. The Landlord reserves the right at anytime to relocate, rearrange or alter the buildings and structures, other leased premises, and Common Area and Facilities, and the Lease Premises from that shown on the plan. All information, dimensions, sizes and areas are approximate only and are to be verified on site. In-premises washroom locations are subject to verification.

PARK PLACE PROFESSIONAL BUILDING

Sherwood Park, Alberta

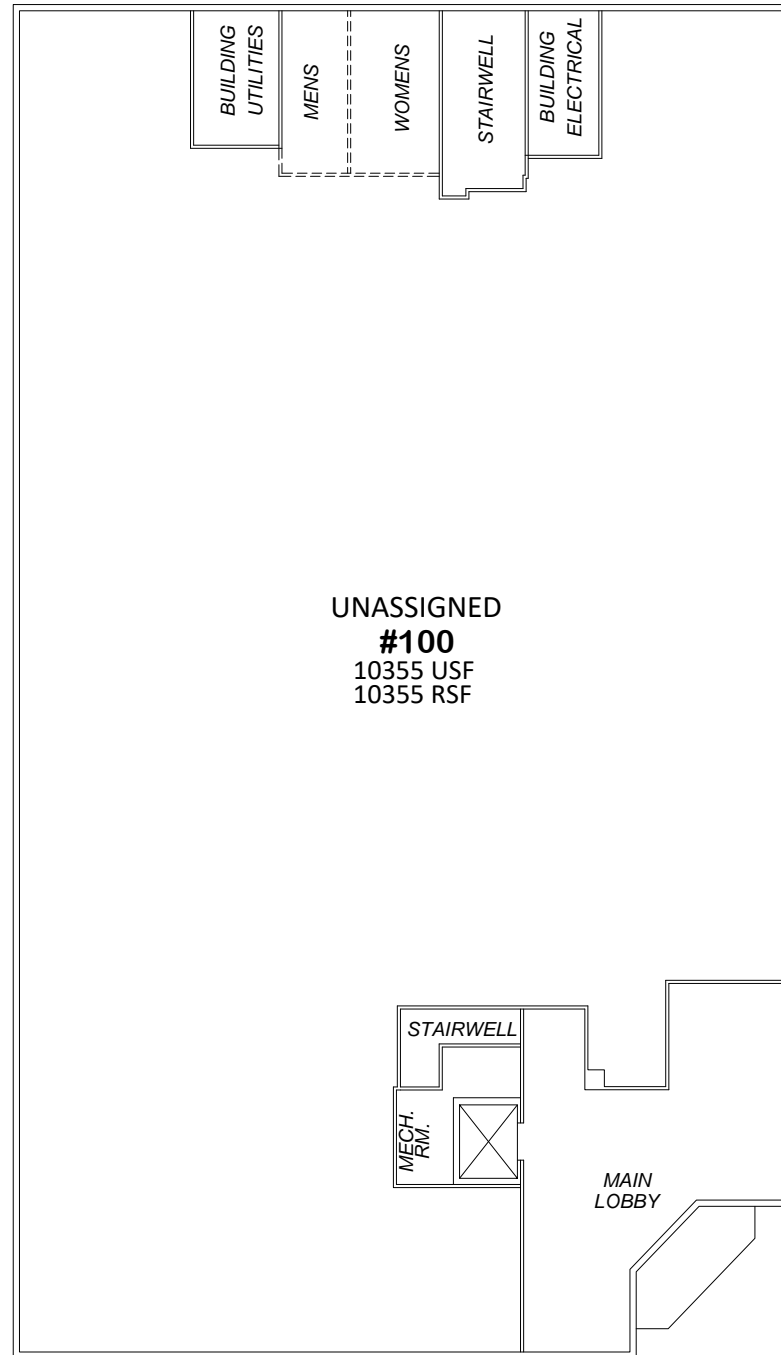

main floor

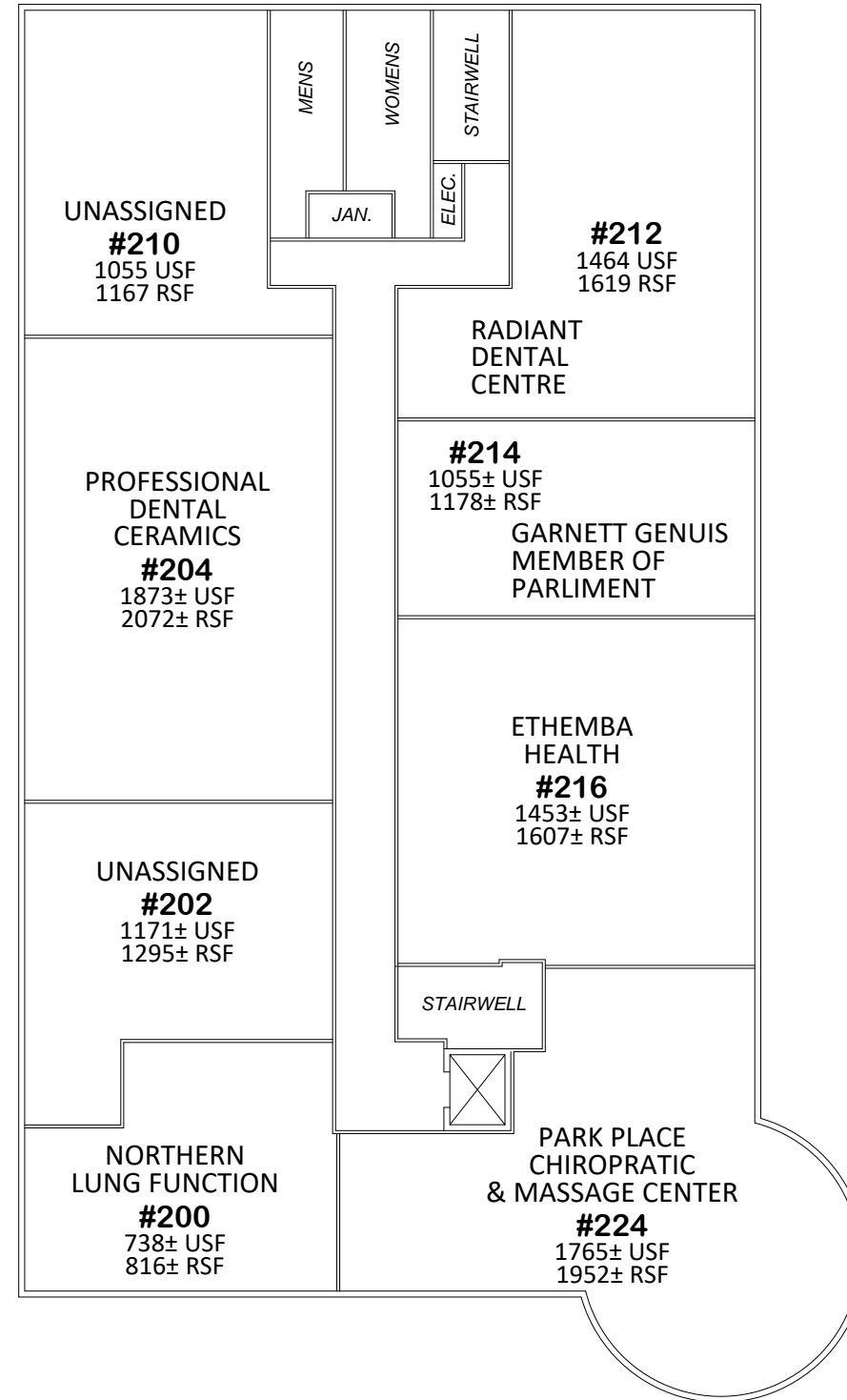

second floor

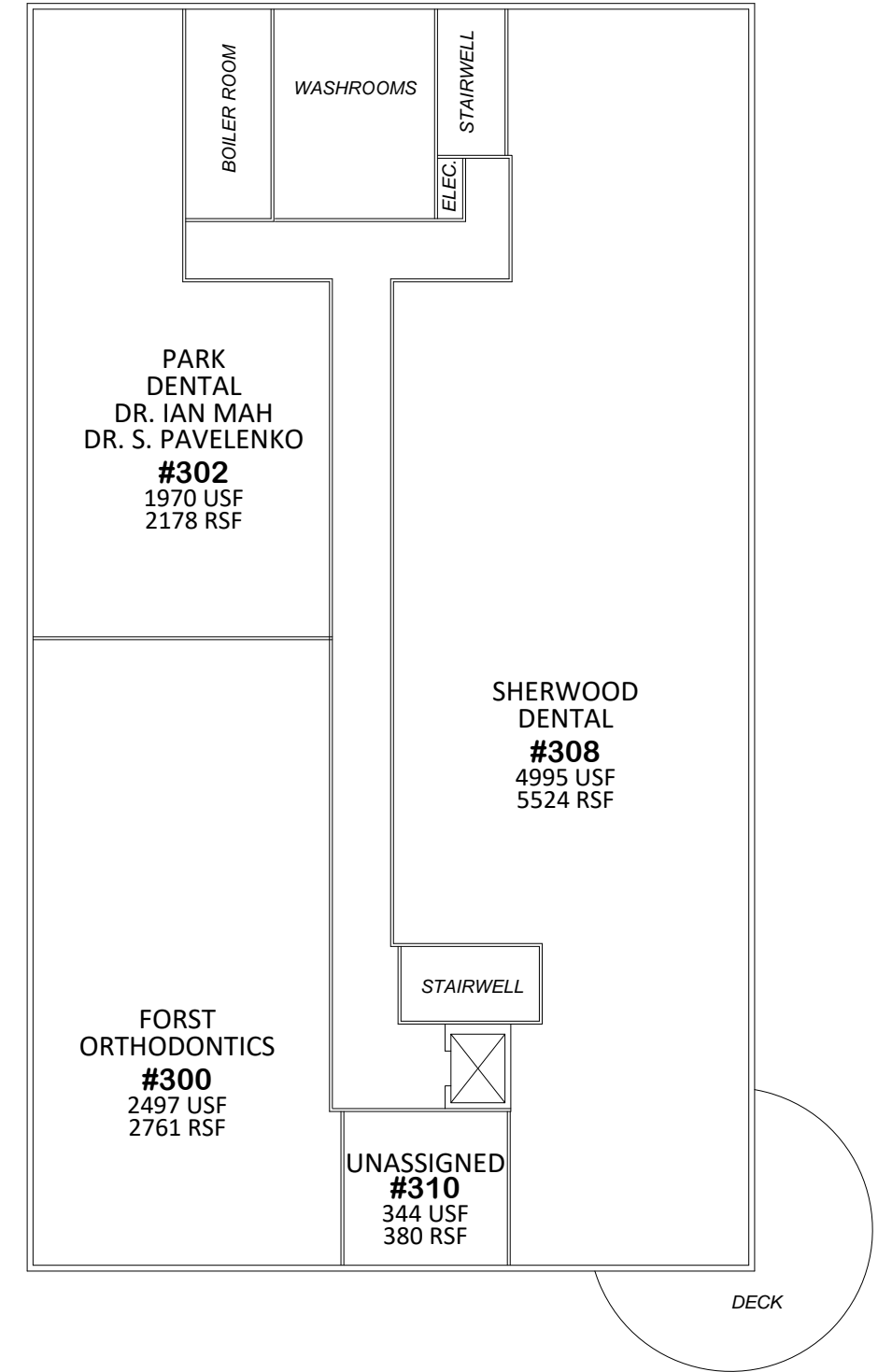

third floor

SHERWOOD PARK MALL

Sherwood Park, Alberta

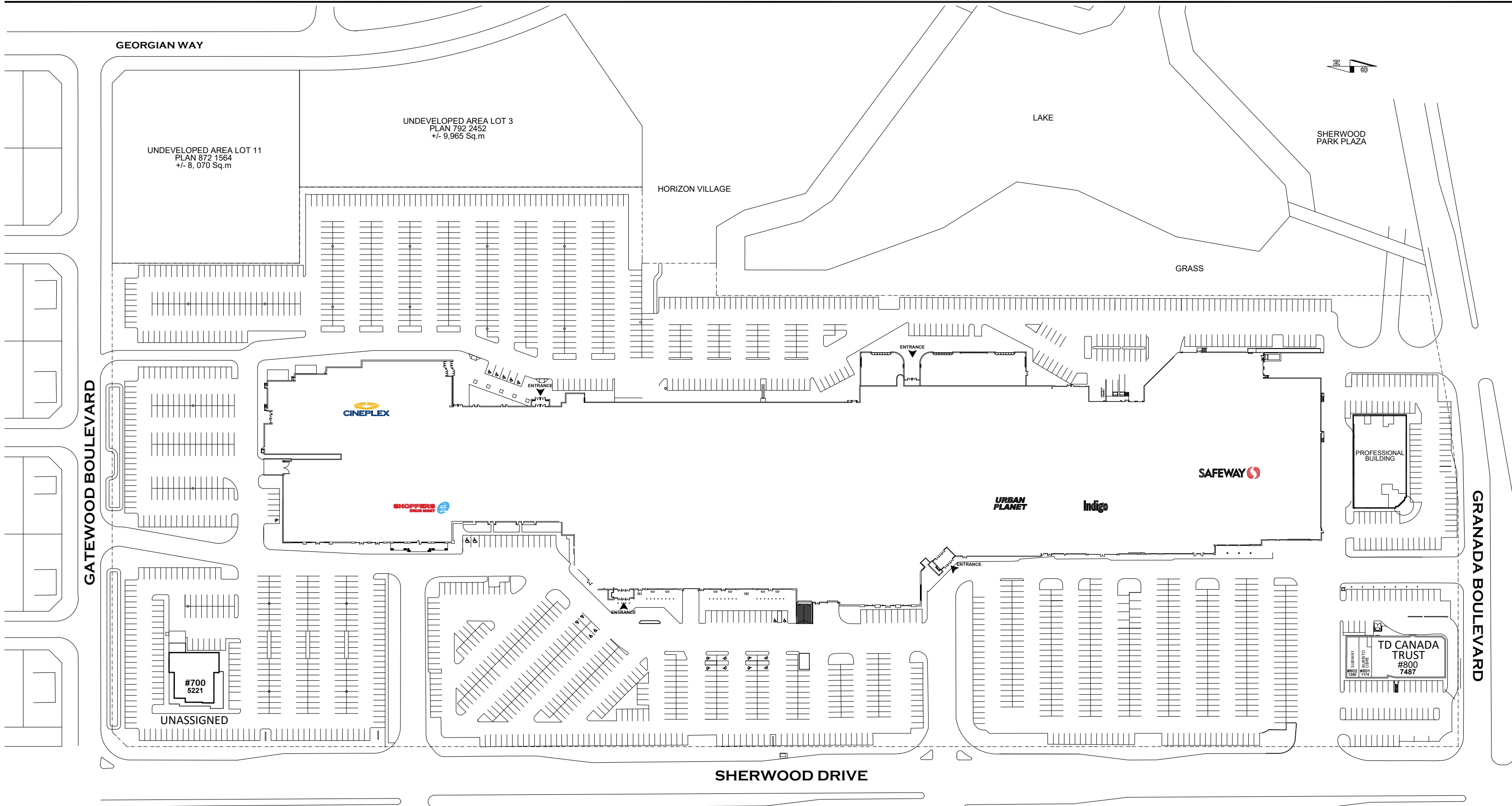

site plan

Primaris * June 02, 2022

The Purpose of this plan is to identify the approximate location, size and dimension of the Lease premises in the Shopping Centre. The Landlord reserves the right at anytime to relocate, rearrange or alter the buildings and structures, other leased premises, and Common Area and Facilities, and the Lease Premises from that shown on the plan. All information, dimensions, sizes and areas are approximate only and are to be verified on site. In-premises washroom locations are subject to verification.