



## KEY INFORMATION:

- the largest enclosed shopping centre in the northeast quadrant of Winnipeg
- trade area has expanded since 2011 and encompasses the city's entire northeast quadrant, with growth in the northwest and southeast, as well as nearby rural towns
- CRU productivity: \$587 (Jan 2023)
- Approximate GLA: 403,248 square feet
- 101 Stores
- 2,313 Parking Stalls

## LOCATION:

- good highway access to customers in the east and nearby rural towns
- located in the hub of the city's largest retail node east of the Red River
- recent extension of Chief Peguis Trail has improved access from the northwest
- adjacent to Government of Canada Taxation Centre (over 1,200 employees)

## MARKET:

- strong concentration of high-income households in the area
- 482,859 population of total trade area (2021)
- 181,784 households in total trade area
- \$95,609 average household income
- 36.6% shoppers with income over \$100K

For a full list of retailers and hours of operation, please visit the Centre's website at [www.kildonanplace.com](http://www.kildonanplace.com)

## KILDONAN PLACE IS ANCHORED BY:

**SHOPPERS**  
DRUG MART



**H&M**



**save on foods**

**URBAN  
PLANET**

Director of Leasing  
Craig McLellan  
647-258-3675  
cmclellan@primarisreit.com

Specialty Leasing Manager  
Tracey Lachaine  
204-661-6116 ext 230  
tlachaine@primarisreit.com

General Manager  
Sandra Hagnaars  
204-661-6116 ext 225  
shagnaars@primarisreit.com

**Primaris**

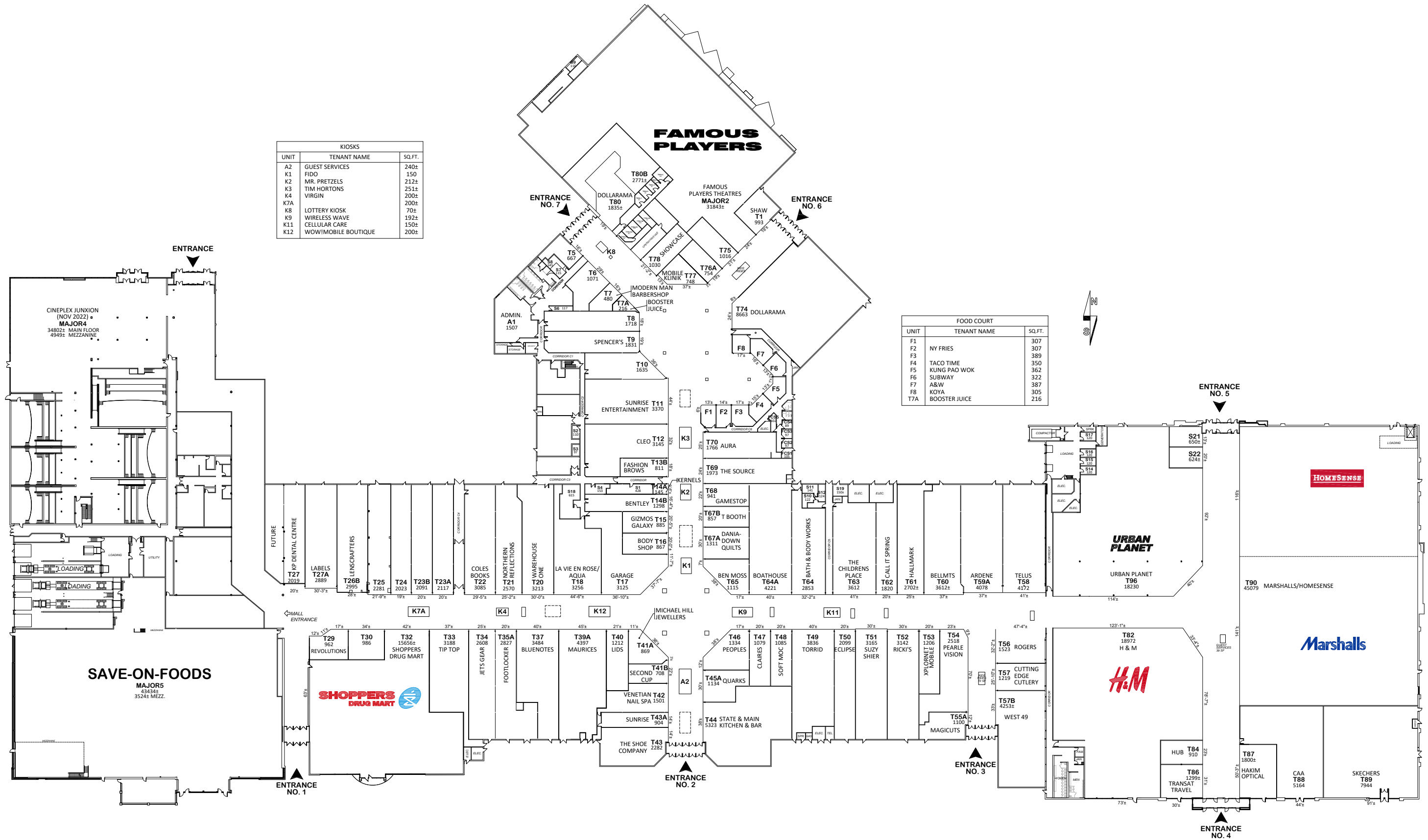

## floor plan - main level

Primaris \* March 02, 2023

The Purpose of this plan is to identify the approximate location, size and dimension of the Lease premises in the Shopping Centre. The Landlord reserves the right at anytime to relocate, rearrange or alter the buildings and structures, other leased premises, and Common Area and Facilities, and the Lease Premises from that shown on the plan. All information, dimensions, sizes and areas are approximate only and are to be verified on site. In-premises washroom locations are subject to verification.

