

**KEY INFORMATION:**

- Over 140 retail shops and services
- Increasingly young and affluent primary customer base
- The largest shopping centre in Wellington County
- Approximate GLA: 517,740 square feet
- CRU Productivity: \$616 (Jan 2023)
- 125 Stores
- 2,552 Parking Stalls

**LOCATION:**

- 435 Stone Road West, Guelph, ON
- Easily accessible to public transit
- Bounded by residential communities and the University of Guelph
- Direct access to Highway 6 and 401
- Ongoing residential development

**MARKET:**

- 219,941 Total Trade Area Population
- 82,793 Total Trade Area Households
- \$118,693 Trade Area Average HH income
- 47.5% Shoppers with income over \$100K

For a complete list of retailers and hours of operations, please visit the Centre's website at [www.stoneroadmall.ca](http://www.stoneroadmall.ca)

**STONE ROAD MALL IS ANCHORED BY:**



**Leasing Manager**  
Heather Wallace  
647-577-3647  
[hwallace@primarisreit.com](mailto:hwallace@primarisreit.com)

**Specialty Leasing Manager**  
Melony Stagg  
519-821-5780 x231  
[mstagg@primarisreit.com](mailto:mstagg@primarisreit.com)

**General Manager**  
Kevin Knight  
519-821-5780 x240  
[kknight@primarisreit.com](mailto:kknight@primarisreit.com)

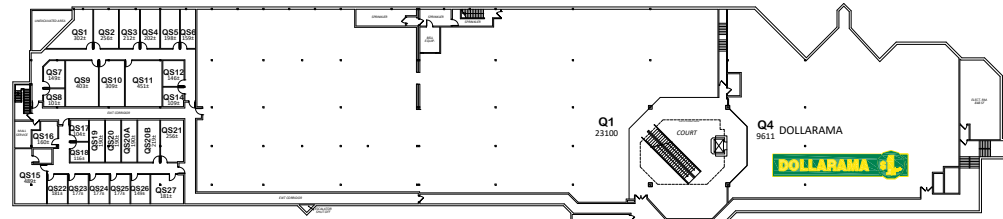

floor plan - lower level

FOOD COURT			KIOSK		
UNIT	TENANT NAME	SQ. FT.	UNIT	TENANT NAME	SQ. FT.
FC1	MR. SOUVLAKI	408	F01	MOBILINO	150
FC2	A & W	400	SLK1	WOW/MOBILE	150
FC3	KFC/TACO BELL	391	V01	BEAUTY BAR	150
FC4	NY FRIES	351	V05	FIDO	200
FC5		388	V08	VIRGIN	200
FC6		437	V09	KOODO	200
FC7		501	V10		150
FC8	SHANGHAI 360	395	Y03	CHATR MOBILE	180
FC9	SUSHI Q	397	Y09	KERNELS	169
FC10		456	Y10		200
P24	FUTURE	845	ZK02	WIRELESS WAVE	200
P25	WILLIAMS CAFÉ				

\* = deemed

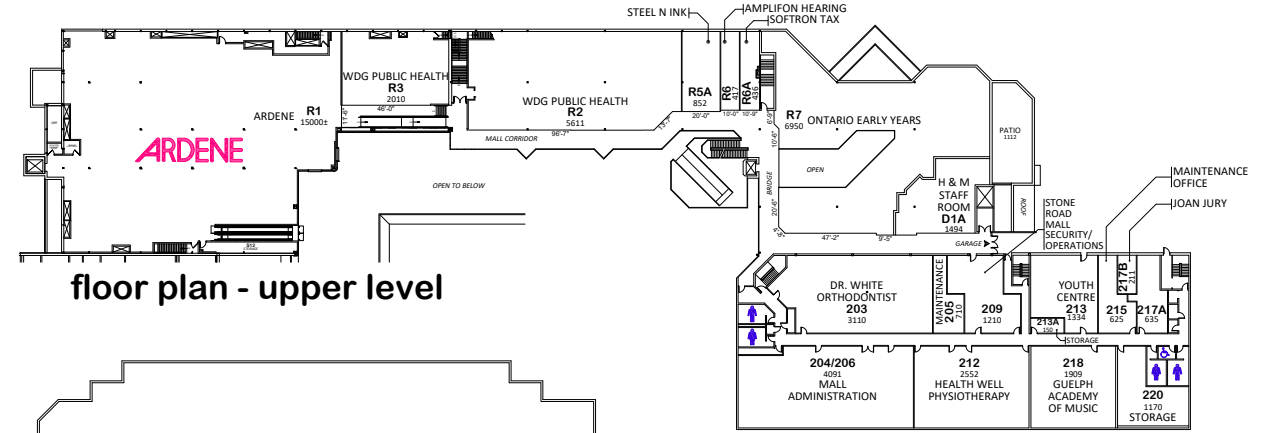

floor plan - upper level

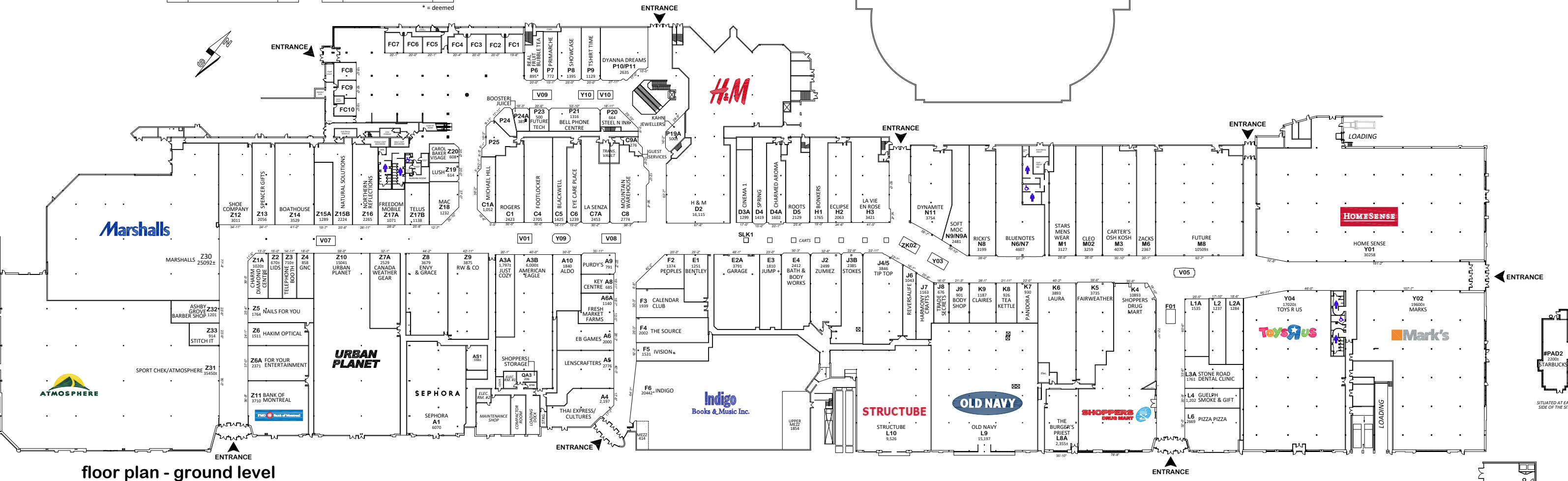

floor plan - ground level

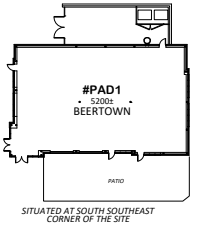

# STONE ROAD MALL

Guelph, Ontario

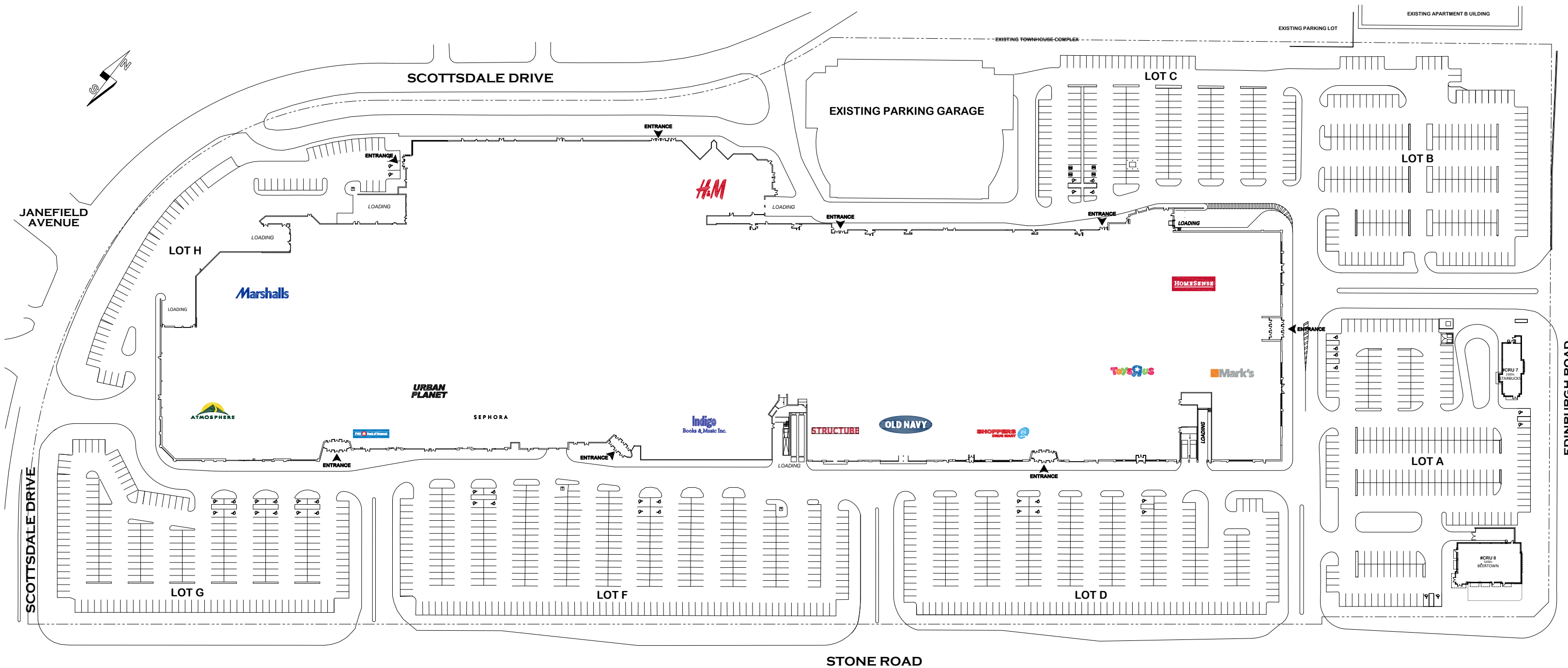

## site plan

Primaris \* March 02, 2023

The Purpose of this plan is to identify the approximate location, size and dimension of the Lease premises in the Shopping Centre.  
The Landlord reserves the right at anytime to relocate, rearrange or alter the buildings and structures, other leased premises, and Common Area and Facilities, and the Lease Premises from that shown on the plan.  
All information, dimensions, sizes and areas are approximate only and are to be verified on site.  
In-premises washroom locations are subject to verification.