



KEY INFORMATION:

- well established regional shopping centre located in the affluent Northwest quadrant of Calgary
- over 70 shops and services on site including a full service food court, a professional centre, and several free standing tenants
- Approximate GLA: 520,000 square feet
- CRU Productivity: \$438 psf (Dec 2019)

LOCATION:

- 5111 Northland Drive NW, Calgary, AB
- easily accessible from and adjacent to two major traffic arteries (Crowchild Trail and Shaganappi Trail)
- close proximity to three schools and two post-secondary institutions

MARKET:

- 1,341,766 population of total trade area.
- 490,569 households in total trade area
- \$146,993 average household income in PTA
- 1,391,867 daytime population
- \$139,116 average household income in PTA (higher than the average income for the Calgary Metropolitan Area (CMA) of \$137,094)

For a complete list of retailers and hours of operation, please visit the Centre's website at www.northlandvillagemall.com

NORTHLAND VILLAGE MALL IS ANCHORED BY:



Vice President of Leasing
Laurel Adamson
403-984-1939
ladamson@primarisreit.com

General Manager
Sarah Cumming
403-974-0040
scumming@primarisreit.com

Specialty Leasing Manager
Stacie Woolford
403-816-3521
SWoolford@primarisreit.com



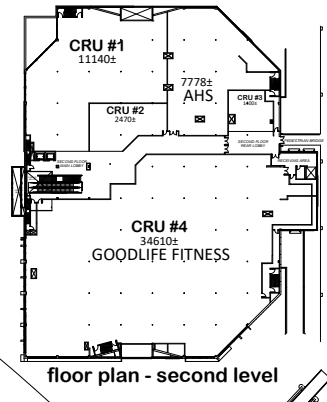
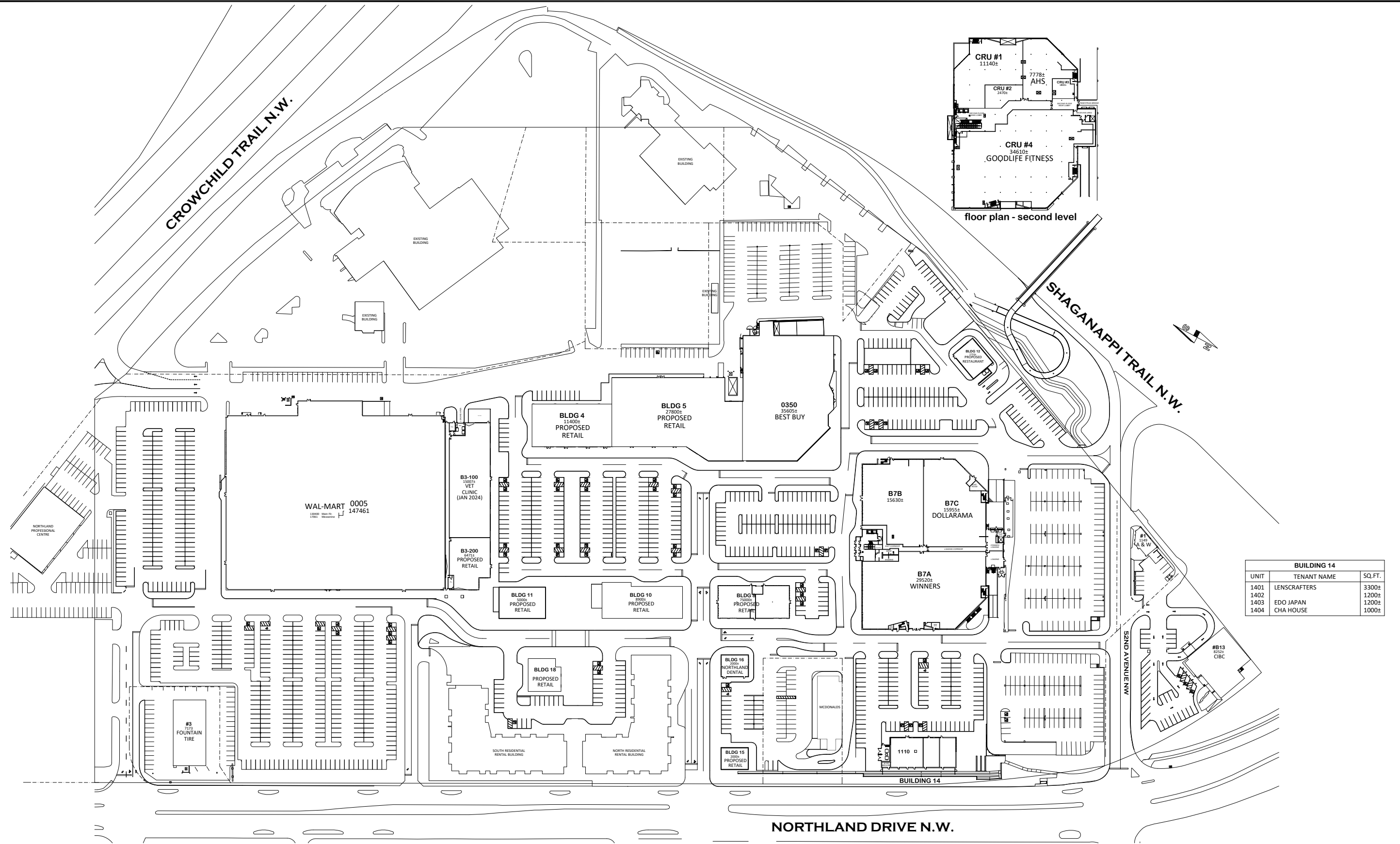

| BUILDING 14 | | |
|-------------|--------------|---------|
| UNIT | TENANT NAME | SQ. FT. |
| 1401 | LENSCRAFTERS | 3300± |
| 1402 | | 1200± |
| 1403 | EDO JAPAN | 1200± |
| 1404 | CHA HOUSE | 1000± |

floor plan - main level

Primaris * March 02, 2023

The Purpose of this plan is to identify the approximate location, size and dimension of the Lease premises in the Shopping Centre. The Landlord reserves the right at anytime to relocate, rearrange or alter the buildings and structures, other leased premises, and Common Area and Facilities, and the Lease Premises from that shown on the plan. All information, dimensions, sizes and areas are approximate only and are to be verified on site. In-premises washroom locations are subject to verification.